

FLT Series

Fe:ZnSe/S Tunable Mid-IR Laser

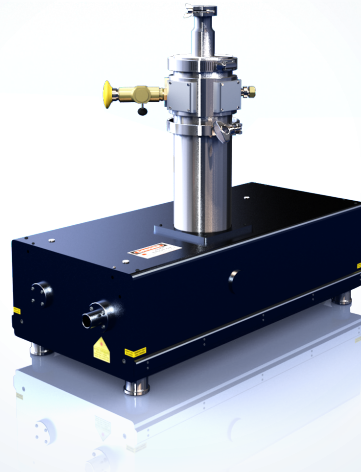

Applications

- ▶ Spectroscopy
- ▶ Sensing
- ▶ Medical
- ▶ Seeding or Pumping Mid-IR OPOs
- ▶ Defense



Features

- ▶ Tuning Range 3.7 - 4.8 μm
- ▶ TEM_{00} Beam Mode
- ▶ Output Power > 300 mW
- ▶ Linear Polarization

Tuning Curve of FLT Series Laser¹

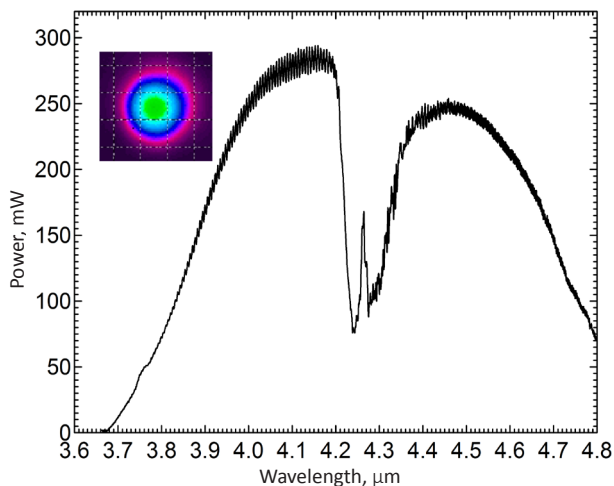

¹The dip between 4.2-4.4 μm , due to intracavity CO_2 absorption, can be eliminated via cavity purging with inert gas.

IPG's FLT is a tunable Fe:ZnSe/S continuous wave laser featuring a narrow linewidth and a cryogenic cooling system. It provides > 100 mW of output power across a 3.7 - 4.8 μm tuning range, generating > 300 mW at the peak of the tuning curve. The spectral linewidth is < 1 nm with a beam mode of TEM_{00} . The FLT laser is pumped by IPG Photonics' efficient and reliable erbium fiber laser. IPG's FLT laser is used in a number of applications including pumping Mid-IR OPOs, spectroscopy, sensing, medical and defense.

FLT Series

Fe:ZnSe/S Tunable Mid-IR Laser

Optical Characteristics

Mode of Operation	CW, tunable wavelength
Wavelength Range, nm	3700 - 4800
Spectral Linewidth, nm	< 1
Average Output Power, mW	> 50 across tuning range, > 300 at 4.2 μm
Polarization	Linear or Horizontal
Beam Mode Quality, M ²	> 1.2
Beam Diameter* (FW, 1/e ²), mm	3 typ.
Beam Divergence, mrad	2 typ.
Warm up Time, min	15 from standby, 60 min from cold start

*Beam diameter may be adjusted to meet customer specifications.

General Characteristics

Pump Laser **	IPG Photonics CW Erbium or Thulium Fiber Laser
Pump Laser Dimensions (WxDxH), mm	448 x 403 x 132
Optical Head Dimensions (WxDxH), mm	258 x 578 x 150
Gain Element Operation Temperature***, K	77 - 220
Supply Voltage, 50 - 60 Hz, VAC	110 - 240
Power Consumption, W	200 typ.

**Pump laser model depends on the combination of parameters.

***Optimal operating temperature of a gain element depends on wavelength.

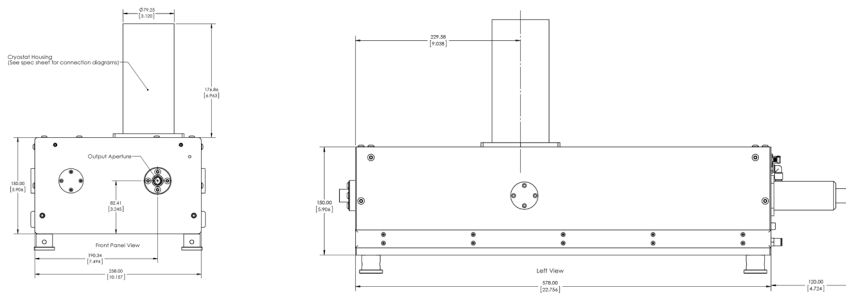

+1 (205) 307-6677

sales.us@ipgphotonics.com

www.ipgphotonics.com/midIR

Legal notices: All product information is believed to be accurate and is subject to change without notice. Information contained herein shall legally bind IPG only if it is specifically incorporated into the terms and conditions of a sales agreement. Some specific combinations of options may not be available. The user assumes all risks and liability whatsoever in connection with use of a product or its application. IPG, IPG Photonics, The Power to Transform and IPG Photonics' logo are trademarks of IPG Photonics Corporation. © 2012 - 2015 IPG Photonics Corporation. All rights reserved. Protected by US patents 5,541,948; 6,960,486; 7,548,571 and applicable licenses.

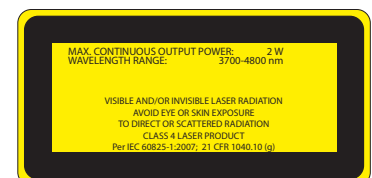

The Power to Transform®